

# MIAMIBEACH

OFFICE OF THE CITY MANAGER

LTC # **145-2020**

LETTER TO COMMISSION

TO: Mayor Dan Gelber and Members of the City Commission

FROM: Jimmy L. Morales, City Manager

DATE: March 26 ,2020

SUBJECT: **RUE VENDOME PUBLIC PLAZA**

The purpose of this Letter to Commission is to update the Mayor and City Commission on the status of the project to construct a public plaza at Rue Vendome, adjacent to the Normandy Fountain, in North Beach, specifically the removal of trees from the project site.

On March 3, 2020, the City broke ground on the construction that will permanently close (to vehicular traffic), that portion of Rue Vendome between 71 Street and Normandy Drive, to create a public plaza which will extend to the area around the Normandy Fountain. Ten (10) existing Washingtonia palms and four (4) existing Live Oak trees shall be removed to facilitate the creation of the larger open area for congregation (Attachment A). The CIP team has worked closely with the project's arborist, the City's Urban Forester, the Parks and Recreation Department and the Green Space Division, to develop a strategy to minimize trees needing to be removed. Unfortunately, (4) Live Oak trees are not good candidates for relocation because they have a compromised root structure and their health is declining due to lack of nutrients. The (10) Washingtonia palms are non-native, invasive species and are also not candidates for relocation.

City of Miami Beach permit number UF2019-0472 was approved for the removal of the trees and palms. All mitigation requirements will be met with the installation of trees as a part of this construction project (Attachment B). Five (5) Live Oak and Eleven (11) Crepe Myrtle trees shall be provided to mitigate the loss of the four Live Oaks, increasing the tree canopy, and shade within the new space. Thirty-four (34) Lady Palms and Twelve (12) Montgomery Palms are being added to create more shade within the space. Nine (9) existing Medjool Palms shall remain, with one (1) additional Medjool, located at the southwest corner of the fountain, being relocated on site. Additionally, numerous shrubs and ground cover are scheduled for installation in the area around the fountain.

The trees scheduled to be removed, have been tagged as required by City Ordinance No. 2019-4308, 1,10-16-19 since February 12, 2020, and the removal is scheduled to start on Wednesday, April 1, 2020.

Should you have any questions, please contact David Martinez at 305-673-7071.

Attachment A: Existing Tree Disposition Plan

Attachment B: Plaza Rendering

  
JLM/ATH/DM

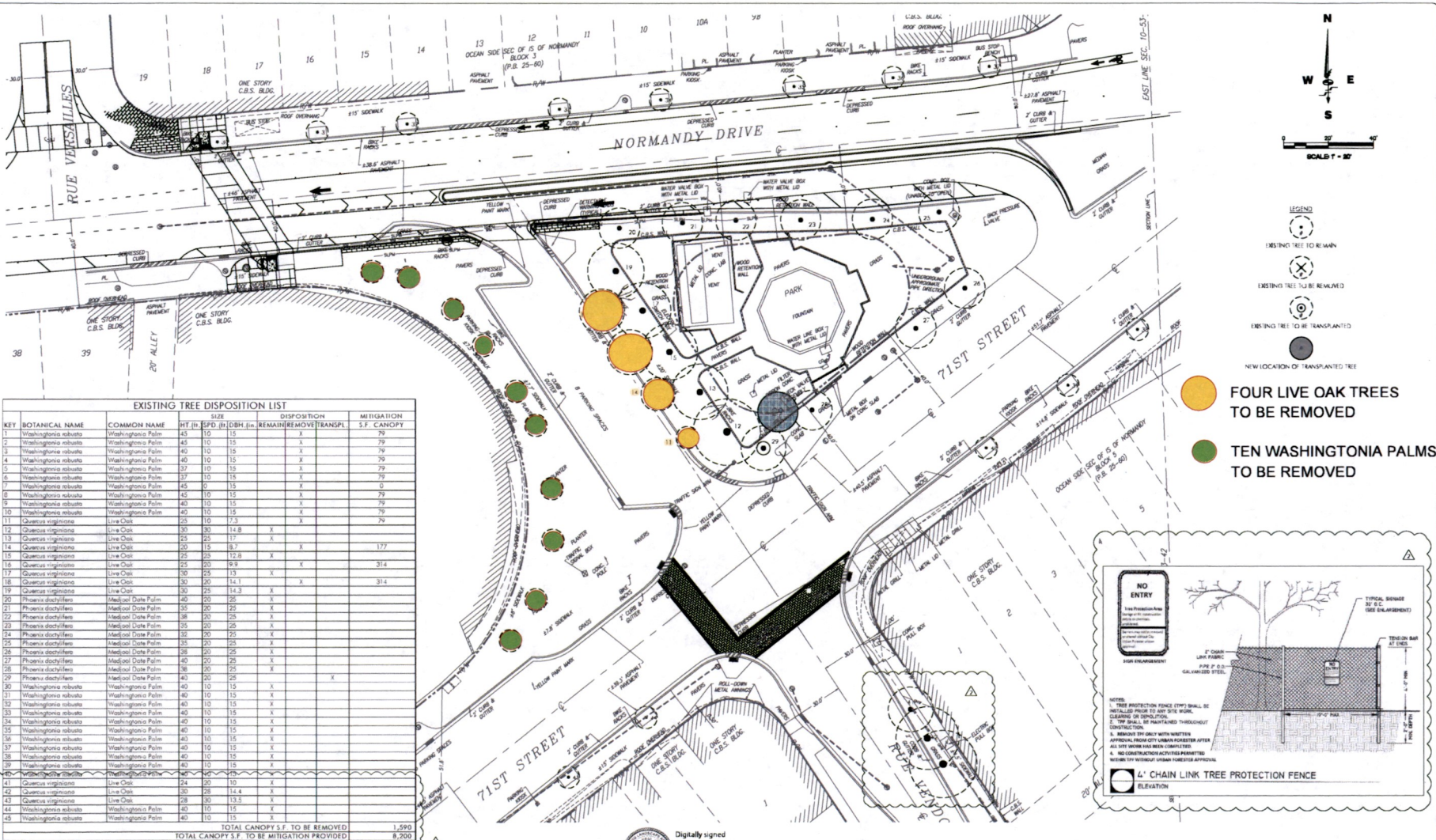

EXISTING TREE DISPOSITION LIST									
KEY	BOTANICAL NAME	COMMON NAME	HT (ft)	SPD (ft)	DBH (in)	DISPOSITION	MITIGATION	S.F. CANOPY	
						REMAIN	REMOVE	TRANSPL	
1	Washingtonia robusta	Washingtonia Palm	45	10	15	X			79
2	Washingtonia robusta	Washingtonia Palm	45	10	15	X			79
3	Washingtonia robusta	Washingtonia Palm	40	10	15	X			79
4	Washingtonia robusta	Washingtonia Palm	40	10	15	X			79
5	Washingtonia robusta	Washingtonia Palm	37	10	15	X			79
6	Washingtonia robusta	Washingtonia Palm	37	10	15	X			79
7	Washingtonia robusta	Washingtonia Palm	45	10	15	X			79
8	Washingtonia robusta	Washingtonia Palm	45	10	15	X			79
9	Washingtonia robusta	Washingtonia Palm	40	10	15	X			79
10	Washingtonia robusta	Washingtonia Palm	40	10	15	X			79
11	Quercus virginiana	Live Oak	25	10	17.3	X			79
12	Quercus virginiana	Live Oak	30	30	14.8	X			314
13	Quercus virginiana	Live Oak	25	25	17	X			177
14	Quercus virginiana	Live Oak	25	15	18.1	X			314
15	Quercus virginiana	Live Oak	25	25	12.8	X			314
16	Quercus virginiana	Live Oak	25	20	9.9	X			314
17	Quercus virginiana	Live Oak	10	25	13	X			314
18	Quercus virginiana	Live Oak	30	30	14.1	X			314
19	Quercus virginiana	Live Oak	30	25	14.3	X			314
20	Phoenix dactyloides	Medjool Date Palm	40	20	25	X			314
21	Phoenix dactyloides	Medjool Date Palm	55	20	22	X			314
22	Phoenix dactyloides	Medjool Date Palm	38	20	25	X			314
23	Phoenix dactyloides	Medjool Date Palm	35	20	25	X			314
24	Phoenix dactyloides	Medjool Date Palm	35	20	25	X			314
25	Phoenix dactyloides	Medjool Date Palm	35	20	25	X			314
26	Phoenix dactyloides	Medjool Date Palm	35	20	25	X			314
27	Phoenix dactyloides	Medjool Date Palm	40	20	25	X			314
28	Phoenix dactyloides	Medjool Date Palm	38	20	25	X			314
29	Phoenix dactyloides	Medjool Date Palm	40	20	25	X			314
30	Washingtonia robusta	Washingtonia Palm	45	10	15	X			79
31	Washingtonia robusta	Washingtonia Palm	40	10	15	X			79
32	Washingtonia robusta	Washingtonia Palm	40	10	15	X			79
33	Washingtonia robusta	Washingtonia Palm	40	10	15	X			79
34	Washingtonia robusta	Washingtonia Palm	40	10	15	X			79
35	Washingtonia robusta	Washingtonia Palm	40	10	15	X			79
36	Washingtonia robusta	Washingtonia Palm	40	10	15	X			79
37	Washingtonia robusta	Washingtonia Palm	40	10	15	X			79
38	Washingtonia robusta	Washingtonia Palm	40	10	15	X			79
39	Washingtonia robusta	Washingtonia Palm	40	10	15	X			79
40	Washingtonia robusta	Washingtonia Palm	40	10	15	X			79
41	Quercus virginiana	Live Oak	24	30	10	X			1,590
42	Quercus virginiana	Live Oak	30	28	14.4	X			8,200
43	Quercus virginiana	Live Oak	28	30	13.5	X			
44	Washingtonia robusta	Washingtonia Palm	40	10	15	X			
45	Washingtonia robusta	Washingtonia Palm	40	10	15	X			
TOTAL CANOPY S.F. TO BE REMOVED									1,590
TOTAL CANOPY S.F. TO BE MITIGATION PROVIDED									8,200

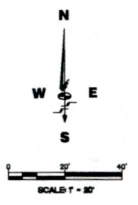

- LEGEND
- EXISTING TREE TO REMAIN
  - EXISTING TREE TO BE REMOVED
  - EXISTING TREE TO BE TRANSPLANTED
  - NEW LOCATION OF TRANSPLANTED TREE

- FOUR LIVE OAK TREES TO BE REMOVED
- TEN WASHINGTONIA PALMS TO BE REMOVED

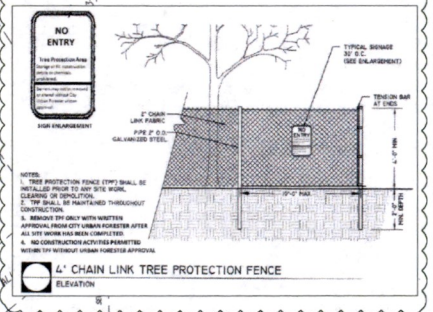

Digitally signed by Ken Gardner  
Date: 2019.06.10 09:55:40 -0400

PERMIT SET

**MIAMI BEACH**  
OFFICE OF CAPITAL IMPROVEMENT PROJECTS  
1700 GOVERNOR CENTER DRIVE, MIAMI BEACH, FL 33139

NEIGHBORHOOD: **NORMANDY ISLES**  
TITLE: **RUE VENDOME PLAZA**

Sub-consultant  
**GL**

ENG. OF RECORD: **58679**  
DESIGN ENGINEER: **L.F.L.**  
DRAWN BY: **D.C.T.**  
CHECKER: **L.F.L.**  
SCALE:

LANDSCAPE ARCHITECT OF RECORD: **3**  
**4**  
**3**  
**2** 6/17/19 FDOT/BDG DEPT CMNTS  
**1** 11/19/19 80% DESIGN PROGRESS SUBMITTAL

Drawing Title: **EXISTING TREE DISPOSITION PLAN**  
Drawing No.: **LA1.01**

APP'D. BY: **KEG**  
Date: **03-13-2019**  
Sheet: **1** OF **16**  
File No.: **AJ-5476**

ATTACHMENT "B"

